

**PVC FOLYO FREZELENMİŞ GÖRÜNÜM**  
**MILLED PVC FOIL VIEW**

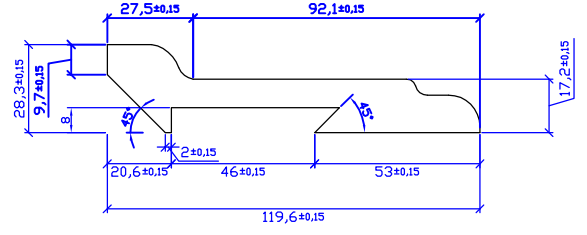

**HG FOLYO FREZELENMİŞ GÖRÜNÜM**  
**MILLED HG FOLIO VIEW**

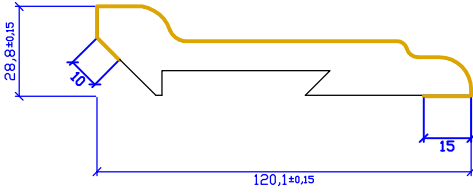

**PVC FOLYO KAPLANMIŞ GÖRÜNÜM**  
**PVC FOLIO COATING VIEW**

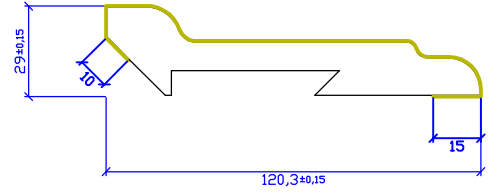

**HG FOLYO KAPLANMIŞ GÖRÜNÜM**  
**HG FOLIO COATING VIEW**

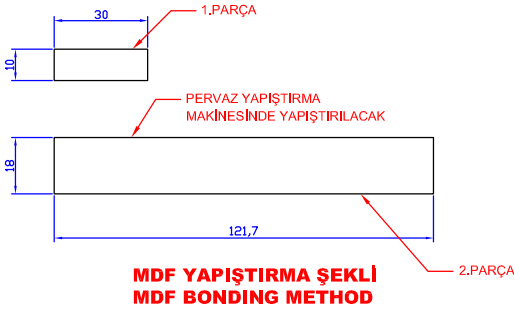

**MDF YAPIŞTIRMA ŞEKLİ**  
**MDF BONDING METHOD**

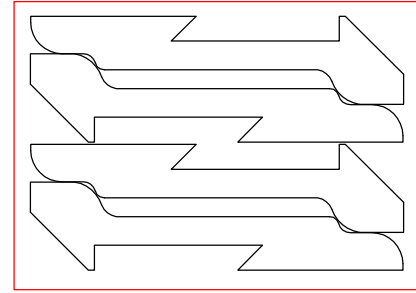

**PAKETLEME ŞEKLİ GÖRÜNÜM**  
**PACKAGING VIEW**

**NOT: SÜPÜRGE LİĞİN MONTAJINDA**  
**PR04667 KODLU KARKAS PROFİLİ KULLANILACAKTIR**

GENEL TOLERANS TABLOSU	
GENEL TOLERANS:	*± 0,15mm
<b>PROFİL BOYLARINDA STANDART FOLYO RENKLERİNDE HER İKİ TARAFTA ± 7 ŞER mm (14mm) TOLERANS VARDIR - FINİŞ KAGIT FOLYOLARDA HER İKİ TARAFTA -25mm (50mm) TOLERANS VERDİR. *Boy toleransı en az olarak verilmiştir; daha kısa olmaz</b>	
"Bu ürünü ham almanız halinde tarafımızdan yapılacak üst yüzey işlemleri sonucu oluşabilecek sorunlarda firmamız sorumlu değildir."	
TOLERANCE CHART	
OVERALL TOLERANCE:	*± 0,15mm
<b>THERE IS AN OVERALL TOLERANCE OF ± 7 mm (14 mm) ON BOTH SIDES OF PROFILES COVERED WITH STANDARD FOIL COLORS - THE TOLERANCE ON PROFILES COVERED WITH FINISH FOIL IS -25 mm (50 mm) ON BOTH SIDES OF PROFILE. *The length tolerance value indicated above is minimum, can't be any shorter"</b>	
"Our company is not responsible for problems will occur on surface in case of buying the raw product and treating by yourself."	

**AGT**

AGT AĞAÇ SANAYİ VE TİCARET A.Ş.

BU DOKÜMAN AGT AĞAÇ SANAYİ VE TİCARET A.Ş.'NE AİTTİR. YAZILI İZİN OLMASIZIN KISMEN VEYA TAMAMEN ÇOĞALTILMAMAK ÜRETİLMEMEK VE KOPYA EDİLMEMEK ŞARTİLE VERİLMİŞTİR.

This document belongs to AGT AĞAÇ SANAYİ VE TİCARET A.Ş.; copying and duplicating a part of this document is not allowed without having any permission.

ONAYLAMA VE TASARIM BİLGİLERİ

CİZEN DRAWN BY:	CİZİM KONTROL: DWG CHK	ÜRETİM KONTROL: PRODUCTION CONTROL	KALİTE KONTROL: QUALITY CONTROL	FOLYO KONTROL: FOLIO CONTROL	SON KONTROL: FINAL CONTROL	TASARIM ADI: DESIGN NAME	KONTROL NO: CONTROL NO:	MÜŞTERİ ADI: CUSTOMER NAME	MALZEME: MATERIAL	TEKNİK ÖZELLİKLER: TECHNICAL SPECIFICATION	RESİM ÜZERİNDE ÖLÇÜ ALINMAZ DO NOT SCALE DRAWING
ŞÜKRÜ KURAL	OĞUZ ŞENER	RAMAZAN PEKER MUSTAFA YILMAZ	BİROL DEMIREZEN	HAKAN ÇİÇEK	-	SU00172_3	01	AGT TASARIM	MDF	KALINLIK / mm: 29	123-F-001
22/04/2016	...					ÜRETİM GRUBU PROFİL BÖLÜMÜ				GENİŞLİK / mm: 120	REVİZYON TARİHİ:
										BOY / mm: 2800	21/10/2016

SAYFA / PAGE : 1 / 1

SERBEST

REVİZYON TARİHİ:

21/10/2016

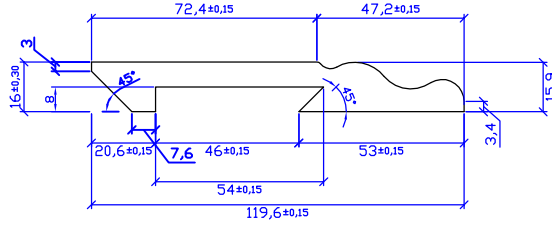

**PVC FOLYO FREZELENMİŞ GÖRÜNÜM**  
**MILLED PVC FOIL VIEW**

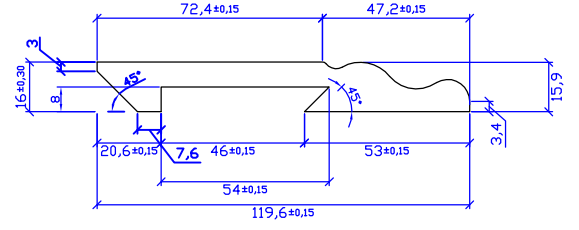

**HG FOLYO FREZELENMİŞ GÖRÜNÜM**  
**MILLED HG FOLIO VIEW**

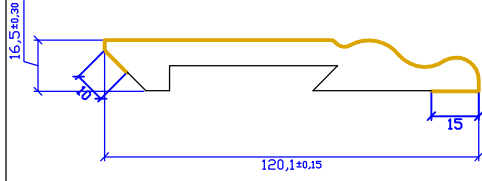

**PVC FOLYO KAPLANMIŞ GÖRÜNÜM**  
**PVC FOLIO COATING VIEW**

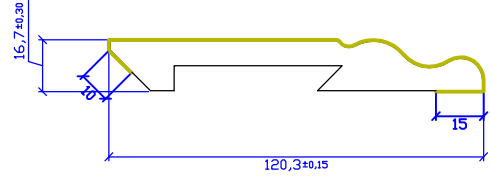

**HG FOLYO KAPLANMIŞ GÖRÜNÜM**  
**HG FOLIO COATING VIEW**

**NOT: SÜPÜRGELİĞİN MONTAJINDA**  
**PR04667 KODLU KARKAS PROFİLİ KULLANILACAKTIR**

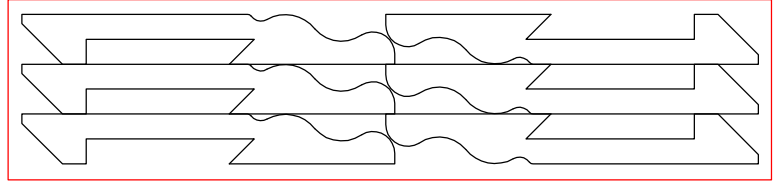

**PAKETLEME ŞEKLİ GÖRÜNÜM**  
**PACKAGING VIEW**

**GENEL TOLERANS TABLOSU**

GENEL TOLERANS: "+ -" 0,15mm

**PROFİL BOYLARINDA STANDART FOLYO RENKLERİNDE HER İKİ TARAFTA +- 7 ŞER mm (14mm) TOLERANS VARDIR - FİNİŞ KAĞIT FOLYOLARDA HER İKİ TARAFTA -25mm (50mm) TOLERANS VERDİR. "Boy toleransı en az olarak verilmiştir, daha kısa olamaz"**

"Bu ürünü ham almanız halinde tarafınızdan yapılacak üst yüzey işlemleri sonucu oluşabilecek sorunlarda firmamız sorumlu değildir."

**TOLERANCE CHART**

OVERALL TOLERANCE: "+ -" 0,15mm

**THERE IS AN OVERALL TOLERANCE OF +- 7 mm (14 mm) ON BOTH SIDES OF PROFILES COVERED WITH STANDARD FOIL COLORS - THE TOLERANCE ON PROFILES COVERED WITH FINISH FOIL IS -25 mm (50 mm) ON BOTH SIDES OF PROFILE. "The length tolerance value indicated above is minimum, can't be any shorter"**

"Our company is not responsible for problems will occur on surface in case of buying the raw product and treating by yourself."



AGT AĞAÇ SANAYİ VE TİCARET A.Ş.

**ONAYLAMA VE TASARIM BİLGİLERİ**

CİZEN DRAWN BY:	CİZİM KONTROL: DWG CHK	ÜRETİM KONTROL: PRODUCTION CONTROL	KALİTE KONTROL: QUALITY CONTROL	FOLYO KONTROL: FOLIO CONTROL	SON KONTROL: FINAL CONTROL	TASARIM ADI: DESIGN NAME	KONTROL NO: CONTROL NO:	MÜŞTERİ ADI: CUSTOMER NAME	MALZEME: MATERIAL	TEKNİK ÖZELLİKLER: TECHNICAL SPECIFICATION	RESİM ÜZERİNDEN ÖLÇÜ ALINMAZ DO NOT SCALE DRAWING
ŞÜKRÜ KURAL	OĞUZ ŞENER	RAMAZAN PEKER MEHMET ÇALGIN	BİROL DEMIREZEN	HAKAN ÇİÇEK	-	SU00173_2	01	AGT TASARIM	MDF	KALINLIK / mm: 16	123-F-001
BU DOKÜMAN AGT AĞAÇ SANAYİ VE TİCARET A.Ş.'NE AİTTİR. YAZILI İZİN OLMASIZIN KISMEN VEYA TAMAMEN ÇOĞALTILMAMAK ÜRETİLMEMEK VE KOPYA EDİLMEMEK ŞARTİLE VERİLMİŞTİR.											
This document belongs to AGT AĞAÇ SANAYİ VE TİCARET A.Ş. copying and duplicating a part of this document is not allowed without having any permission											
22/04/2016	.....					.....	.....	.....		GENİŞLİK / mm: 120	REVİZYON TARİHİ:
						.....	.....	.....		BOY / mm: 2800	13/05/2016

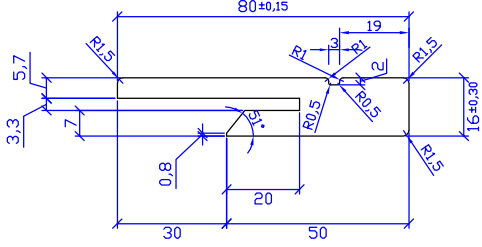

**PVC FOLYO FREZELENMİŞ GÖRÜNÜM**  
**MILLED PVC FOIL VIEW**

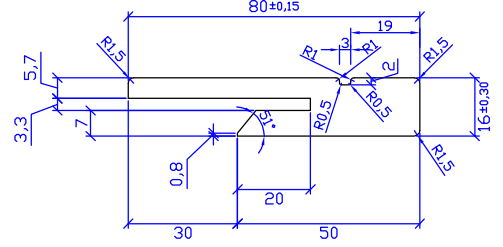

**HG FOLYO FREZELENMİŞ GÖRÜNÜM**  
**MILLED HG FOLIO VIEW**

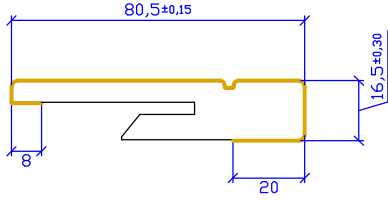

**PVC FOLYO KAPLANMIŞ GÖRÜNÜM**  
**PVC FOLIO COATING VIEW**

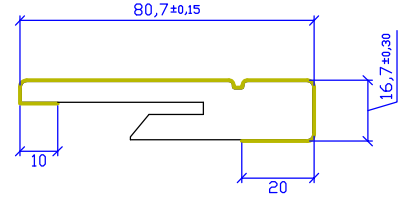

**HG FOLYO KAPLANMIŞ GÖRÜNÜM**  
**HG FOLIO COATING VIEW**

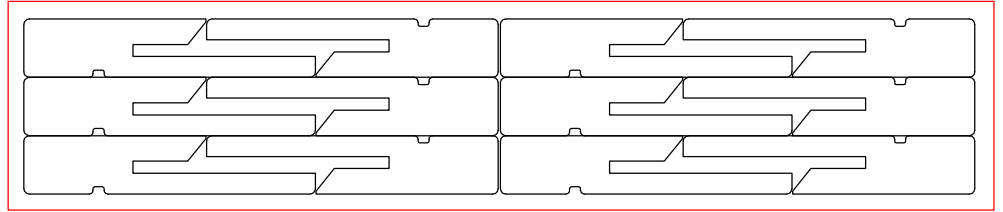

**PAKETLEME ŞEKLİ GÖRÜNÜM**  
**PACKAGING VIEW**

**GENEL TOLERANS TABLOSU**

GENEL TOLERANS:	*± 0,15mm
<b>PROFİL BOYLARINDA STANDART FOLYO RENKLERİNDE HER İKİ TARAFTA ± 7 ŞER mm (14mm) TOLERANS VARDIR - FINİŞ KAGIT FOLYOLARDA HER İKİ TARAFTA -25mm (50mm) TOLERANS VERDİR. *Boy toleransı en az olarak verilmiştir; daha kısa olamaz</b>	
"Bu ürünü ham alınmaz hallerinde tasarımdan yapılacak işçiyi işlemleri sonucu oluşabilecek sorunlarda firmamız sorumlu değildir."	

**TOLERANCE CHART**

OVERALL TOLERANCE:	*± 0,15mm
<b>THERE IS AN OVERALL TOLERANCE OF ± 7 mm (14 mm) ON BOTH SIDES OF PROFILES COVERED WITH STANDARD FOIL COLORS - THE TOLERANCE ON PROFILES COVERED WITH FINISH FOIL IS -25 mm (50 mm) ON BOTH SIDES OF PROFILE. *The length tolerance value indicated above is minimum, can't be any shorter</b>	
"Our company is not responsible for problems will occur on surface in case of buying the raw product and treating by yourself."	



AGT AĞAÇ SANAYİ VE TİCARET A.Ş.

BU DOKÜMAN AGT AĞAÇ SANAYİ VE TİCARET A.Ş.'NE AİTTİR. YAZILI İZİN OLMASIZ KESİMEN VEYA TAMAMEN ÇOĞALTILMAMAK ÜRETİLMEMEK VE KOPYA EDİLMEMEK ŞARTI İLE VERİLMİŞTİR.

This document belongs to AGT AĞAÇ SANAYİ VE TİCARET A.Ş. copying and duplicating a part of this document is not allowed without having any permission

**ONAYLAMA VE TASARIM BİLGİLERİ**

ÇİZEN DRAWN BY	ÇİZİM KONTROL DWG CHK	ÜRETİM KONTROL PRODUCTION CONTROL	KALİTE KONTROL QUALITY CONTROL	FOLYO KONTROL FOLIO CONTROL	SON KONTROL FINAL CONTROL	TASARIM ADI DESIGN NAME	KONTROL NO: CONTROL NO:	MÜŞTERİ ADI: CUSTOMER NAME	MALZEME: MATERIAL	TEKNİK ÖZELLİKLER: TECHNICAL SPECIFICATION	RESİM ÜZERİNDEN ÖLÇÜ ALINMAZ DO NOT SCALE DRAWING
ŞÜKRÜ KURAL	OĞUZ ŞENER	RAMAZAN PEKER MUSTAFA YILMAZ	BİROL DEMİREZEN	HAKAN ÇİÇEK	-	SU05030_1	01	AGT TASARIM	MDF	KALINLIK / mm: 16	123-F-001
12/01/2015	...					.....	.....	.....		GENİŞLİK / mm: 80	REVİZYON TARİHİ:
						.....	.....	.....		BOY / mm: 2800	06/10/2016

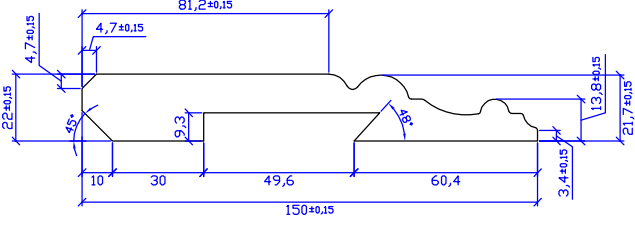

**PVC FOLYO FREZELENMİŞ GÖRÜNÜM**  
**MILLED PVC FOIL VIEW**

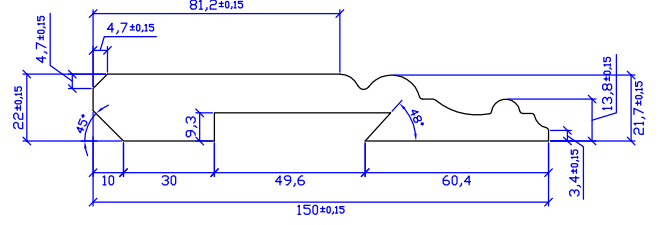

**HG FOLYO FREZELENMİŞ GÖRÜNÜM**  
**MILLED HG FOLIO VIEW**

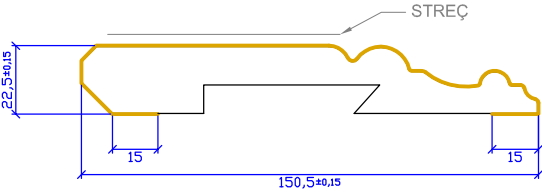

**PVC FOLYO KAPLANMIŞ GÖRÜNÜM**  
**PVC FOLIO COATING VIEW**

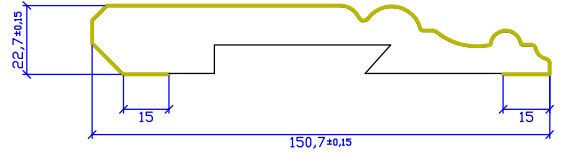

**HG FOLYO KAPLANMIŞ GÖRÜNÜM**  
**HG FOLIO COATING VIEW**

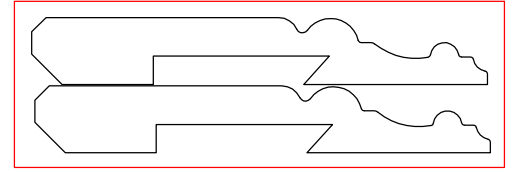

**PAKETLEME ŞEKLİ GÖRÜNÜM**  
**PACKAGING VIEW**

GENEL TOLERANS TABLOSU	
GENEL TOLERANS:	*± 0.15mm
<b>PROFİL BOYLARINDA STANDART FOLYO RENKLERİNDE HER İKİ TARAFTA ± 7 ŞER mm (14mm) TOLERANS VARDIR - FINİŞ KAĞIT FOLYOLARDA HER İKİ TARAFTA -25mm (50mm) TOLERANS VERDİR. *Boy toleransı en az olarak verilmiştir; daha kısa olamaz*</b>	
<b>"Bu ürünü ham almanız halinde tarafımızdan yapılacak üst yüzey işlemleri sonucu oluşabilecek sorunlarda firmamız sorumlu değildir."</b>	
TOLERANCE CHART	
OVERALL TOLERANCE:	*± 0.15mm
<b>THERE IS AN OVERALL TOLERANCE OF ± 7 mm (14 mm) ON BOTH SIDES OF PROFILES COVERED WITH STANDARD FOIL COLORS - THE TOLERANCE ON PROFILES COVERED WITH FINISH FOIL IS -25 mm (50 mm) ON BOTH SIDES OF PROFILE. *The length tolerance value indicated above is minimum, can't be any shorter*</b>	
<b>"Our company is not responsible for problems will occur on surface in case of buying the raw product and treating by yourself."</b>	



AGT AĞAÇ SANAYİ VE TİCARET A.Ş.

BU DOKÜMAN AGT AĞAÇ SANAYİ VE TİCARET A.Ş.'NE AİTTİR. YAZILI İZİN OLMASIZIN KİSMEN VEYA TAMMEN ÇOĞALTIYIMAK ÜRETİLMEMEK VE KOPYA EDİLMEMEK ŞARTİLE VERİLMİŞTİR.

This document belongs to AGT AĞAÇ SANAYİ VE TİCARET A.Ş. copying and duplicating a part of this document is not allowed without having any permission.

ONAYLAMA VE TASARIM BİLGİLERİ

ÇİZEN DRAWN BY:	ÇİZİM KONTROL: DWG CHK:	ÜRETİM KONTROL: PRODUCTION CONTROL:	KALİTE KONTROL: QUALITY CONTROL:	FOLYO KONTROL: FOLIO CONTROL:	SON KONTROL: FINAL CONTROL:	TASARIM ADI: DESIGN NAME	KONTROL NO: CONTROL NO:	MÜŞTERİ ADI: CUSTOMER NAME	MALZEME: MATERIAL	TEKNİK ÖZELLİKLER: TECHNICAL SPECIFICATION		RESİM ÜZERİNDEN ÖLÇÜ ALINMAZ DO NOT SCALE DRAWING
ŞÜKRÜ KURAL	OGUZ ŞENER	RAMAZAN PEKER MUSTAFA YILMAZ	BİROL DEMİREZEN	HAKAN ÇİÇEK	-	SU06040_1	01	AGT TASARIM	MDF	KALINLIK / mm:	22	123-F-001
						.....	.....	SÜPÜRGELİK		GENİŞLİK / mm:	150	REVİZYON TARİHİ:
						.....	.....			BOY / mm:	2800	06/10/216